

PERFECT FIT NEXT GENERATION SYSTEM

ROLLER BLIND WITH CHAIN OPERATION

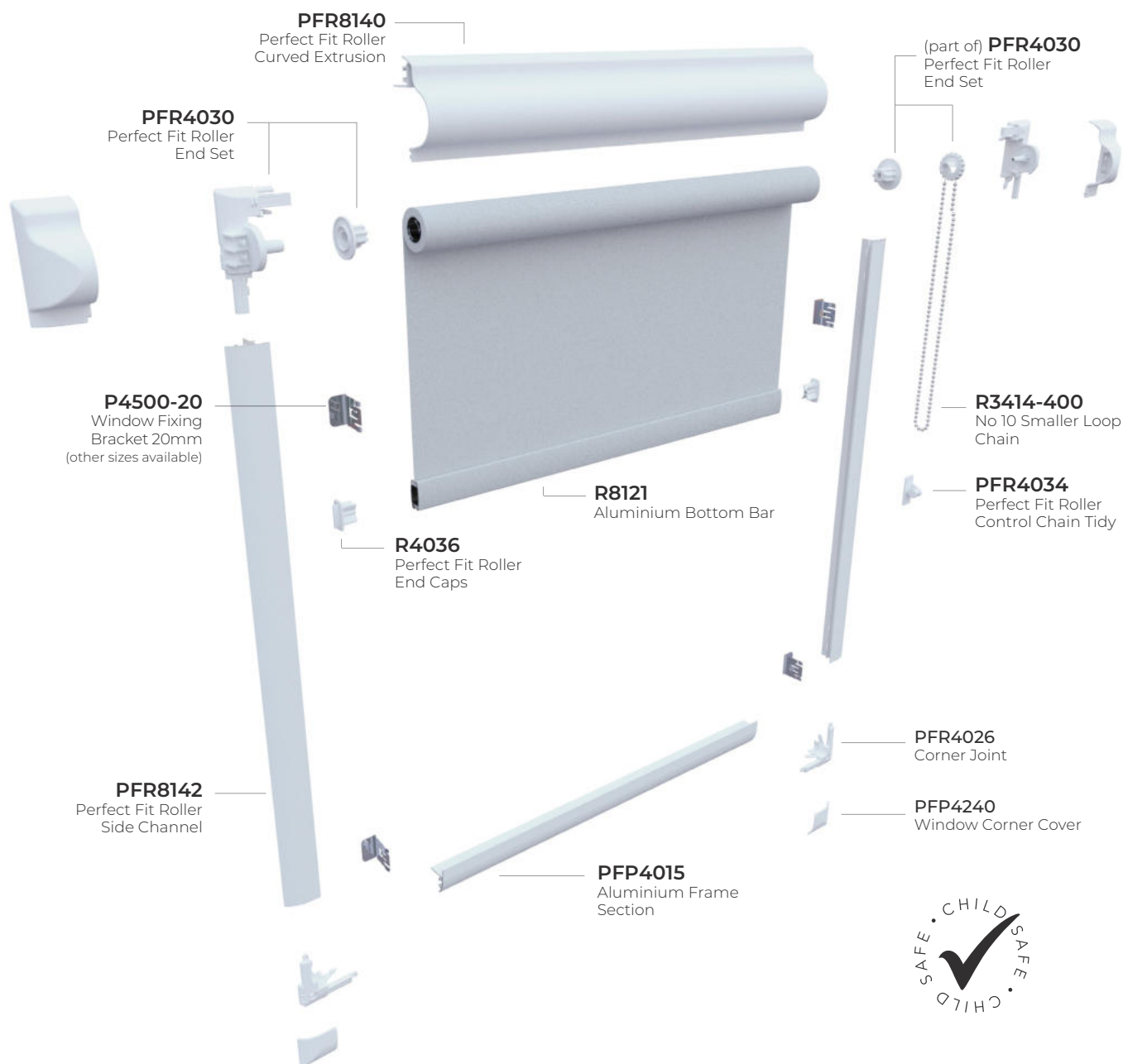

PERFECT FIT NEXT GENERATION ROLLER SYSTEM

- Designed and manufactured in the UK, all Louvolite systems are 10 year life cycle tested to ensure long lasting performance.
- The blind is housed within a neat frame that clicks into uPVC windows and doors and moves with them when they are open, tilted or closed.
- No drilling or screwing needed for installation, the frames just click on using the window fixing brackets and can easily be removed for cleaning.
- Reduces the gaps and light strike at the edge of the blind.
- The looped chain, available as left or right hand, is attached to the Perfect Fit frame with a simple, screwed in cord tidy.
- 18, 20, 22, 24, 26, 28, 30, 32 and 38 brackets to suit most window bead depths.
- End caps with fins keep the bottom bar located in the side channel and away from the window pane.
- Manufactured using high quality engineering grade polymer and aluminium.
- Can be motorised using Louvolite One Touch® Perfect Fit motor R2100 DC.

PERFECT FIT NEXT GENERATION ROLLER

Perfect Fit Next Generation Roller PFR8140 Curved Extrusion

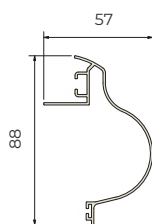

Perfect Fit Next Generation Roller PFR8142 Side Channel

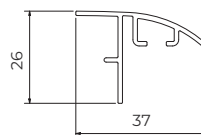

MAX BLIND SIZE

FEATURES	
Blind Width	Max 1.4m
Weight Capacity	2lb

Perfect Fit Next Generation Roller PFR4030 Control Chain End Set

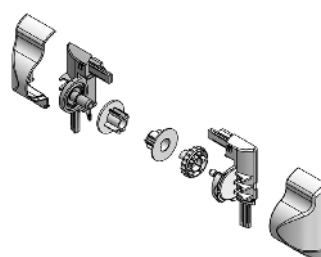

HARDWARE SPECIFICATION

System 25® Perfect Fit Next Generation Roller System

Our motorised roller blinds are manufactured using the Louvolite System 25® roller blind mechanism with specifically designed grooved 25mm aluminium tubing. The specified fabrics are formed and held into the tube with locking tape.

The side control units are made from glass filled Nylon 6, with an acetal sprocket guard, and includes a locking spring.

The operating chain, No.10 size in metal or plastic, ensures reliable performance. The mild steel window fixing brackets are zinc plated and powder coated.

An idle end mechanism is positioned at the opposite end to the control unit, providing a more secure fit of the blind and smooth operation.

Performance

To ensure a positive performance, all Louvolite components are designed and manufactured in the UK using prime quality plastic materials and a dedicated steel locking spring.

10 year life cycle testing is done to ensure long lasting performance.

Operation

Using motorised operation, all blinds must be compliant with the child safety elements of BS EN13120. Where children may be present the chain must be fitted with a cord tidy.

Bottom Bar

Oval, made of aluminium or pvc, can be single or double wrapped in fabric or left exposed. All fabric is formed and held into place with locking tape. Dedicated guide end caps keep the bottom bar in the Perfect Fit side channels and away from the window pane.

Maintenance

All of the Perfect Fit roller blind system components are manufactured using aluminium, treated steel and plastic. They do not present any corrosion problems in normal environments. The system has been designed for a smooth operation, together with a rigidity to prolong the window blind's working life.

Your Louvolite Distributor



CI/SfB 1976 reference by SfB Agency		
(76.7)	X	